

# Products

## JLW dust collector



[view enlarge](#)

The "JLW" model is an industrial small capacity dust collector system equipped with a 3 HP blower generating over 1400 CFM, available in single or three phases electrical connection.

- ▶ [Features](#)
- ▶ [Options](#)
- ▶ [Specifications](#)
- ▶ [Performances curves](#)

This collector is designed to collect dust particles ranging from coarse to mixed sizes, generated by wood machines operating in intermittent or continuous fashions and producing moderate to heavy dust loads.

The JLW unit integrates a high performance industrial blower with top of the line filter bag offering an efficiency of 98.98% @ 0.5 micron. At less than 12 feet high with a foot print less than 4 square feet, the compact design of the JLW makes it ideal for applications where space is a premium.

The JLW unit is generally recommended for applications involving one or two machines in a small shop environment or in larger facilities where there is a need for an industrial "stand alone solution". The JLW dust collector can be configured with various dust removal solutions, ranging from plastic collector bags to 55 gallon steel or plastic drum.

### DISPOSAL OPTIONS

Plastic bag (standard with unit)

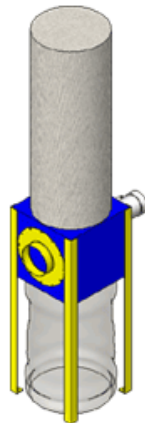

Steel or plastic drum (drum adaptor option)



#### ▶ Features

- Rapid assembly & installation
- Compact configuration offering a small footprint
- Low maintenance direct drive centrifugal fan
- AMCA Class B non-spark aluminium fan wheel
- High efficiency TEFC motor, UL & CSA approved
- High efficiency needle felt filter bag (1/8" thick)
- Quick release clamp
- Five (5) plastic collector bags

#### ▶ Options

- Plastic or steel fifty-five (55) gallon drum
- Plastic collector bags
- Bottom filter bag (23 sq. ft.)
- Magnetic starter in single phase 230 volts
- Magnetic starter in three phases 208/230/460/600 volts

### SPECIFICATIONS

Filtration surface (sq. ft.)	42
Dimensions (W x D x H)(in.)	44"x 24"x130"
Module weight (lbs)	150
Disposal capacity cu/ft	9

Blower Motor (HP)	3
Capacity (CFM)	1400
Sound pressure (dB)	85
Inlet diameter (in.)	7

**PERFORMANCE CURVES**

